

PARTS VIEW

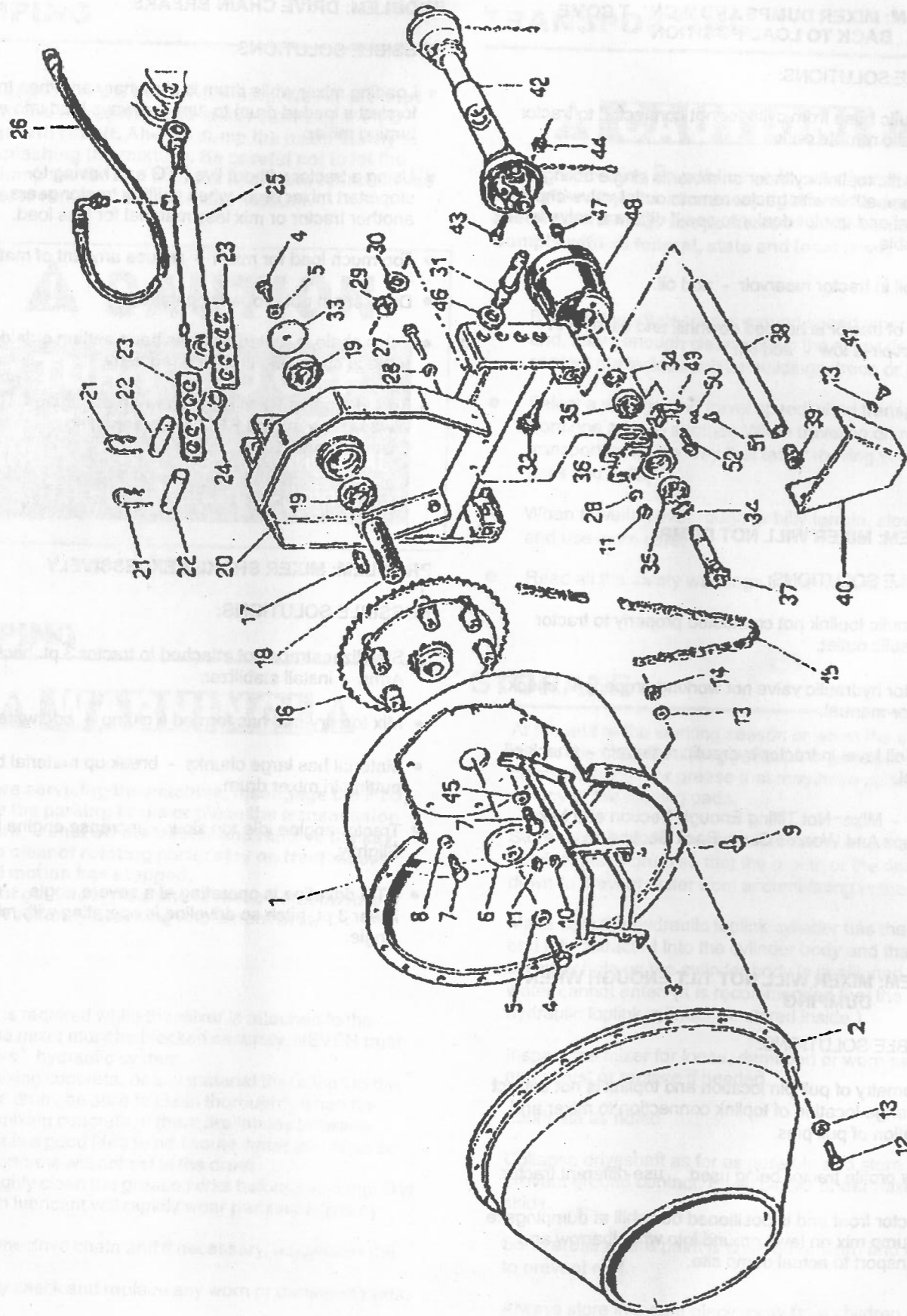

PARTS LIST

Ref No	Description	No. Req'd.
1	Drum, Main	1
2	Drum, Cone	1
3	Paddle, Mixing	3
4	Bolt, M14×30 Gr.8.8 Hex Head	2
5	Washer, M14 External Star	2
6	Washer, Inner	1
7	Bolt, M12×25 Gr.8.8 Hex Head	6
8	Washer, M12 Flat	3
9	Bolt, M12×25 Gr.8.8 Hex Head	6
10	Washer, M12 Flat	6
11	Nut, M12 Hex	8
12	Bolt, M8×16 Gr.8.8 Hex Head	18
13	Washer, M8 Flat	36
14	Nut, M8 Hex	18
15	Chain, #40 (142 Pitches)	1
16	Sprocket Assembly, Drum	1
17	Key, 14×9×50mm	1
18	Shaft, Drum	1
19	Bearing, Ball 6209-2RS	2
20	Frame	1
21	Cotter Pin	4
22	Pin, Cylinder	2
23	Bar, Cylinder Attachment	2
24	Bushing, Cylinder	1
25	Cylinder, Hydraulic-Toplink	1
26	Hoes, Hydraulic	1
27	Bolt, M10×90 Gr.8.8 Hex Head	2
28	Washer M10×30	4
29	Nut, M24 Hex	2
30	Washer, M24 Springlock	2
31	Pin, Pull	2
32	Knob, M8×20	2
33	Washer, Drum Shaft Retainer	1
34	Snap Ring, E D 30	2
35	Bearing, Ball 6200-2RS	2
36	Support, Drive Shaft	1
37	Shaft, Drive w/Sprocket	1
38	Tube, Stand	2
39	Plug, Stand Tube	2
40	Guard, Drive Shaft	1
41	Bolt, M8×16 Gr.8.8 Hex Head	2
42	PTO Shaft 'CE' Standard	1
43	Bolt, M10×50 Socket Head	1
44	Nut, M10 Nylock Hex	1
45	Washer, M12×30 Flat	3
46	Washer, M24 Flat	2
47	Nut, M8 Whiz Flange Hex	2
48	Guard, PTO	1
49	Support, PTO Guard	2
50	Washer, M8 Flat	2
51	Bolt, M8×16 Gr.8.8 Hex Head	2
52	Bolt, M8×20 Gr.8.8 Hex Head	2
N/S	Masterlink, #40 Chain	1